



**Edelstahl-Kombischarnier 30**

**Stainless Steel Combi Hinge 30**

**Beschreibung** aushängbar für Flächenelemente und Aluminiumprofile  
**Material** Flügel: Edelstahl 1.4401  
 Achse: Edelstahl 1.4104  
**Oberfläche** blank  
**Befestigung** vorderseitig mit Senkschrauben M6  
**Liefereinheit** 10 Stück

**Description** Detachable To hinge panels or aluminum profiles  
**Material** Wing: Stainless steel SS316  
 Bolt: Stainless steel SS430 F  
**Surface** Plain  
**Fastening** From the front, using M6 countersunk screws  
**Pack Quantity** 10 pieces

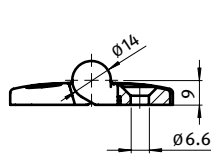
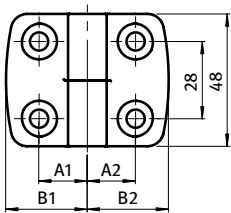

	Bezeichnung Description	A1 [mm]	A2 [mm]	B1 [mm]	B2 [mm]	Gewicht [g] Weight [g]	FMax [N]	FRmax [N]	Teil-Nr. Part #
links <i>Left</i>	30/30	17.5	17.5	29.5	29.5	160.0	710	1000	095E3030L
rechts <i>Right</i>	30/30	17.5	17.5	29.5	29.5	160.0	710	1000	095E3030R